

SpecTrim[®] Handrail is designed for use in Health Care, Institutional, Commercial, and Residential applications.

MATERIALS

Product Description:

- A. SpecTrim[®] Handrail is made of pre-finished wood moldings that have a decorative and protective film surface, 12 to 16 mil thick. The decorative PVC surface film, in the specified finish, is factory applied with adhesive, heat, and pressure to an MDF (medium density fiberboard) core that has been molded into a classically designed ADA shaped hand rail.
- B. Substrate shall be Synergite[®] Medium Density Fiberboard as manufactured by Georgia-Pacific, or equal.
- C. Touch-up material: Manufacturer shall provide wax putty fill sticks to match each specified finish for installation touch-up and fill. Provide quantity sufficient to complete all specified work.
- D. Standard Handrail lengths are produced 10' long unless specified otherwise and shipped to the job site in full lengths.

DELIVERY, STORAGE, AND HANDLING

- A. Deliver, handle, and store in manner to protect products from damage. Product is to be delivered on pallets, corner guarded and cardboard protected, shrink-wrapped, and adequately affixed to a pallet to avoid separation during shipping.
- B. Store products indoors. Product shall be stored in a dry, temperature controlled area. Storage area shall maintain temperatures between 65 - 80 degrees Fahrenheit, and a relative humidity between 25-55%. Products are to be placed in the installation area no less than 48 hours prior to installation to adjust to environmental conditions.

INSTALLATION

SpecTrim[®] Pre-finished Handrail is installed much the same as ornamental wood handrail. For best results, SpecTrim[®] should be placed in the installation area 48 hours prior to installing to adjust to the climate of the room. Cut handrail as required using a powered high speed miter box saw with a sharp 64-tooth triple chip carbide blade. Attach all handrail end returns using the procedure noted below. The following is the recommended installation procedure:

- A. Examine wall conditions before beginning installation of SpecTrim[®] handrail. Verify dimensions and acceptability of wall conditions. Do not proceed with installation of SpecTrim[®] Handrail products until unacceptable conditions have been corrected.
- B. Follow instructions on acclimating the material in the Delivery and Storage information noted above.
- C. Inspect SpecTrim[®] Handrail and End Returns prior to installing each length. Do not install defective or damaged lengths or ends. Install SpecTrim[®] Handrail in accordance with the following manufacturer's installation instructions also available from www.spectrimbp.com.
- D. Measure each wall space and deduct for desired bare wall and end return thicknesses to determine each length that rail is to be cut. Cut SpecTrim[®] Handrail to desired lengths using a power radial saw with a sharpened carbide tipped 64 tooth triple-chip blade. (Always cut the end of the rail a minimum of 3/4" to insure that each end is square and free from defects.) To improve results, back up rail with a wood board when cutting to give support and keep the glue bond stable.

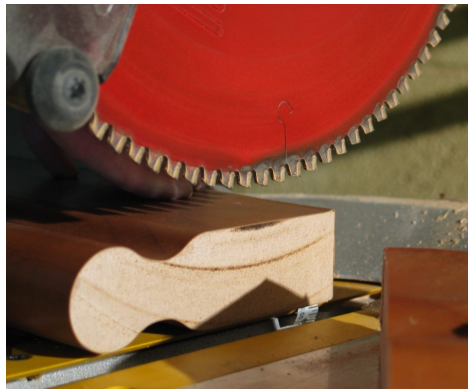

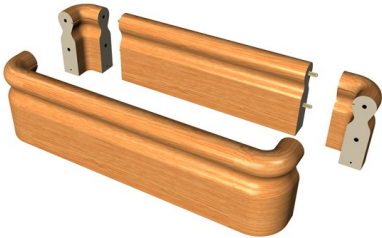

E. Secure the SpecTrim® Handrail Drilling Template to the End of the Rail that you will consider the Left Hand Finished End. Be sure template is flat against the rail face and the rail top with the holes aligned on the rail end. Using an 8mm drill bit, drill the two upper holes through the drilling template. Drill should create each hole 3/4" deep into the end of the SpecTrim® Handrail. Note for a spline joint use all three holes

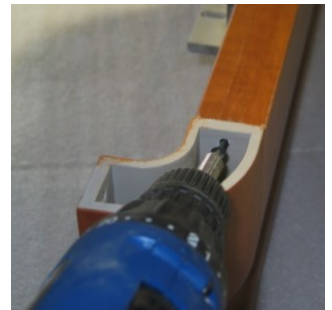
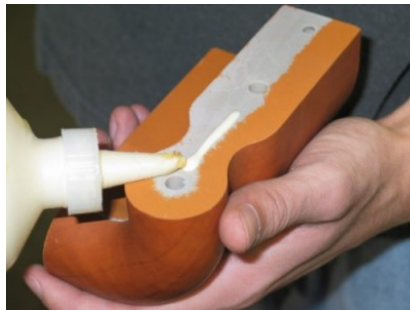
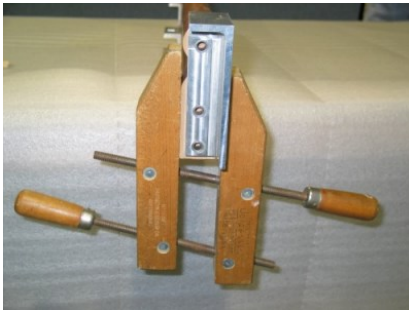

F. Glue 8mm dowels (provided) into the 2 holes drilled in the handrail and glue attach the dowels into the corresponding curved end. Use non-marking tape to temporarily secure the end and allow adhesive to dry thoroughly. Allow glue to dry before proceeding with the next step.

G. From the underside of the end return, drill a pilot hole for a drywall screw on the angle set into the molded end. Drive the screw into the hole on the same angle.

H. Repeat the process for the opposite end return. Be sure to use the opposite side of the template and fit tight to the rail top and front.



The following information and instructions apply to the SpecTrim® Handrail Brackets:

Hardware Included:

Screws to Handrail: two #14 x 1 1/4" phillips flathead wood screws.

Screws to wall: Because wall requirements vary, wall anchors are the responsibility of the installation contractor.

Through Bolt: one 1/4-20 x 1" carriage bolt.

Lock Nut: one 1/4-20 elastic stop nut.



1. Handrail Brackets should be mounted a maximum of 36" apart with a minimum of two brackets per length. Sub-surface blocking is suggested. Wall anchor selection is the responsibility of the installer.
2. Bracket should always be mounted to align with the bottom of the handrail.
3. Each set of handrail brackets consists of two different parts and the necessary hardware. One part is "L" shaped and is attached to the handrail. The other part is "r" shaped and attaches to the wall. The carriage bolt is put through both pieces and using a ratchet set from below, the lock nut is tightened. Note: Always pre-drill SpecTrim® when using screws.

